Leeds Local Offer Live Visitor Guide

Wednesday 25th March 2026
10am till 3pm
at Pudsey Civic Hall



Website: www.leedslocaloffer.org.uk

Facebook: @Leeds Local Offer

WhatsApp: <https://tinyurl.com/LLOWhatsApp>

Email: LLO@leeds.gov.uk



Welcome to Leeds Local Offer Live 2026!

The Leeds Local Offer provides information for children and young people with special educational needs and disabilities (SEND) and their families in a single place.

It shows families what they can expect from a range of local agencies including education, health and social care.

Today's event is an opportunity for you to speak to a range of services and organisations about their offer and how you and your family can access the service they provide.

Should you need any help or have any questions, please speak to one of our friendly staff. We are very happy to help you!



Event Floorplan: Ballroom

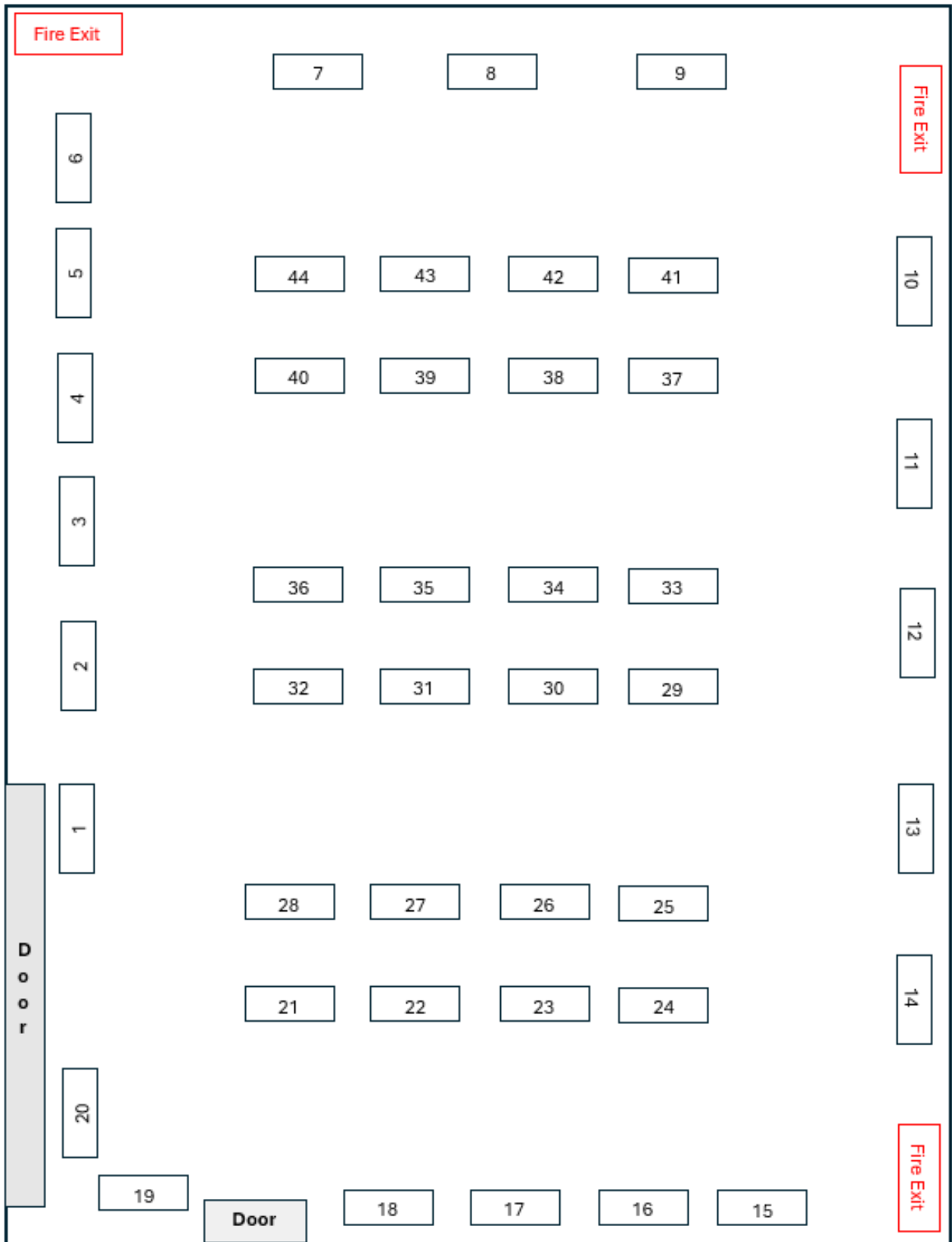

- 1.Children's Centre Family Services and Little Owls Nurseries
- 2.Community Shop
- 3.Family Fund
- 4.Health and Wellbeing Service
- 5.0-19PHINS and Henry
- 6.Kids
- 7.Leeds Mencap
- 8.Leeds SEND Parents and Carers
- 9.Leeds Survivor-Led Crisis Service
- 10.Irwin Mitchell
- 11.SNAPS
- 12.NEUROSTARS
- 13.Refresh Carers
- 14.SENSE Children and Young People's Service
- 15.Sensory World
- 16.ZigZag Leeds Autism Support
- 17.Little Hiccups
- 18.Sunshine and Smiles - Leeds Down Syndrome Network
- 19.Leeds Parent Carer Forum
- 20.Leeds Local Offer
- 21.Scope - support group for parents and carers of children with cerebral palsy
- 22.Through the Maze
- 23.Carers Leeds
- 24.Leeds Sensory Service BID
- 25.Welfare Rights
- 26.Independent Travel Training
- 27.West Yorkshire Combined Authority - Inclusive Travel Team
- 28.Children's Health and Disability (CHAD)
- 29.Transitions Team, Leeds City Council
- 30.Early Help and Family Hubs
- 31.Employment and Skills Leeds
- 32.Neurodiversity Information Hub (CYPMHS NHS)
- 33.Children's Speech and Language Service
- 34.Paediatric Audiologist
- 35.ICAN
- 36.Chatterbug
- 37.Health Facilitation Team
- 38.Short Breaks and Fun Activities, Leeds City Council
- 39.Aireborough Supported Activities Scheme (ASAS)
- 40.Leeds Weekend Care Association
- 41.MathsCity
- 42.Northern Ballet
- 43.People Matters
- 44.RISE Learning Hub Yorkshire



Event Floorplan: Owlcotes Bar

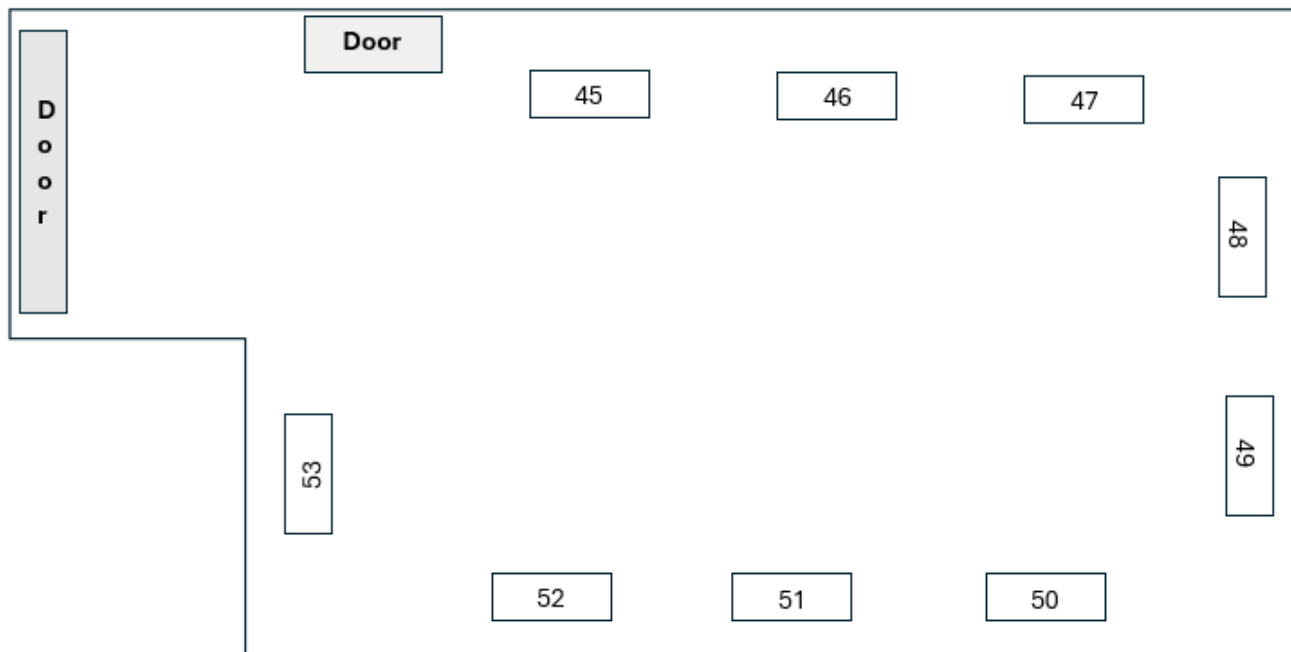

- 45. Calibre Audio
- 46. Pivot Academy
- 47. Learning Inclusion
- 48. Leeds City College
- 49. Leeds Libraries
- 50. Purple Patch Arts
- 51 to 53: SENDIASS

Event Floorplan: Woodhall Room

Lighthouse Futures Trust and Leeds City College will be providing information about Supported Internships.

There will be a mix of information sessions and stalls.



Support for families

Childrens Centre Family Services & Little Owls nurseries

Childrens Centres deliver an integrated offer of support alongside health visitors, midwives, social workers and early help teams. The core purpose is to offer parenting and family support to families. This includes the city wide offer of Preparation Birth and Beyond, Baby Steps, HENRY, Moving onto solids, play and stay groups and targeted preventative support for families with more complex needs.

Little Owls nurseries provide early learning and childcare for children from 6 mths - 5 years. Our nurseries provide good and outstanding provision between 8am and 6pm for working families, families needing additional support, children with complex SEND as well as offering funded early education entitlement places.

Website: www.littleowlsleeds.co.uk

Community Shop

The Community Shop offers affordable groceries and essentials, helping local residents stretch their budgets. It reduces food waste by redistributing surplus stock from supermarkets and suppliers, making healthy food more accessible to everyone.

Community Hub

The Hub is a welcoming space where people can connect, learn, and take part in activities. We host groups, workshops, and events that support wellbeing, reduce isolation, and bring the community together.

Community Kitchen

The Kitchen provides a warm, friendly place to share meals and learn new cooking skills. They run cookery sessions, community lunches, and food projects that encourage healthy eating, build confidence, and create opportunities to socialise.

Email: amelia.hyland-parys@community-shop.co.uk

Website: www.comanyshopgroup.co.uk/our-stores/community-shop



Family Fund

The UK's largest grant-making charity for families raising a disabled or seriously ill child, on a low income. We give grants to families on a low income for items they may not otherwise be able to afford. For example family breaks, digital equipment, white goods, clothing, bedding, furniture and play equipment.

We offer services to help parents and carers to achieve the outcomes they want for their child and family. This includes where to go for support with money, benefits and budget planning, information on mental health and wellbeing. We deliver practical workshops to help people get online and use digital tools.

Email: info@familyfund.org.uk

Website: www.familyfund.org.uk

Health and Wellbeing Service

The HENRY Healthy Families Growing Up Programme is an 8-week course delivered by local HENRY facilitators for parents and carers.

Any parent/carer with at least one child aged between 5 and 12 years can join a programme with available spaces.

HENRY is ideal for any family who would like to find out how the whole family can become healthier and happier together. Our programmes explore key themes such as; well-being, whole family lifestyle habits, mealtimes, TV, sleep, food, behaviour, setting boundaries, parenting and physical activity. Programmes are delivered across Leeds and online and there is no cost to attend.

HENRY is a universal programme for families with children with or without additional needs. HENRY starts with where a family is at and provides tools and support to be able to make changes based on individual family needs and circumstances.

Email: HENRY5-12@leeds.gov.uk

Website: www.schoolwellbeing.co.uk/pages/henry-5-12-parent-s-page

0-19 PHINS / HENRY

HENRY is a universal offer to all parents and carers who have a child within the family home aged 0-5 years. The programme is free 8-week programme and is facilitated by both the 0-19 Public Health Integrated Nursing Service (PHINS) practitioners and Family Help Workers.

Some of the topics discuss are: Managing a child's behaviour, introducing the Eatwell Guide, healthy eating, portion sizes, increasing parental confidence.



Kids

Kids is a leading UK charity for children and young people with special educational needs and disabilities. Kids create life-changing opportunities by providing a wide range of support.

Email: angela.knight@kids.org.uk

Phone: 01482 467540

Website: www.kids.org.uk

Leeds Mencap

Leeds Mencap offers a range of support options for children and young people with learning disabilities and/or autism and other additional needs. We run clubs and playschemes, a club for siblings, a club for 18 - 25 year olds, an early years SEND stay and play session and offer tailored support for families. Our sessions run from the Vinery Centre in LS9.

Leeds Mencap's soft play area and sensory room are also available for families to hire, offering exclusive use of the spaces during the time they are booked for.

Email: info@leedsmencap.org.uk

Phone: 0113 2351331

Website: www.leedsmencap.org.uk

Leeds SEND Parent Carers

Leeds SEND Parents/Carers is a supportive community run by parents of children with SEND, for parents of children with SEND. We understand the challenges and the joys because we live them too.

We provide support in lots of ways: through face-to-face coffee mornings and support groups, and also online via our popular private Facebook group, where parents can connect any time of day. Their aim is to give families a safe space to share experiences, find encouragement, and access useful information.

Alongside this we host inclusive seasonal events and activities where SEND children and their families can relax, connect, and have fun in a welcoming environment.

Email: leedssendparentcarers.events@gmail.com

Website: <https://preview.mailerlite.io/preview/1676853/sites/160526992048915719/LeedsSEND>



Leeds Survivor-Led Crisis Service

Leeds Survivor-Led Crisis Service (LSLCS) provides out-of-hours emotional support to children and young people, their parents and carers, and adults. Whatever you are going through, they will treat you with warmth, kindness, compassion and respect. We offer support face-to-face, over the phone, online, and by text.

LSLCS has three services for children, young people and their parents/carers: Safe Phone, Safe Zone, and West Yorkshire and Barnsley Night OWLS.

Website: www.lslcs.org.uk

Irwin Mitchell

As the largest dedicated medical negligence law firm in the North East, our specialist medical negligence team has many years of experience in cases involving birth injury including cerebral palsy.

Through our legal work at Irwin Mitchell, we understand that if your child lives with a disability or has suffered from a serious injury or illness, the emotional and physical impact can be life changing. We can help you access the best medical care, rehabilitation and support.

We always offer free initial advice and will talk through your legal options so you can make an informed choice about how you wish to move forward.

Website: www.irwinmitchell.com

Phone: 0113 234 3333

SNAPS

SNAPS provides support services for children with additional needs of all kinds, and their families. Children do not need a formal diagnosis to access SNAPS' services. Families can self-refer, or be referred by another organisation. We are based in Leeds, but accept children from any location.

We provide weekly physiotherapist-led hydrotherapy and rebound sessions, along with swimming, arts and crafts, dance and lots more. We also run weekly accessible football sessions for children with additional needs and their siblings. Our Family Support Project delivers more in-depth support for parents and carers between our weekend sessions.

Email: info@snapsyorkshire.org

Website: www.snapsyorkshire.org



NEUROSTARS

NEUROSTARS provides neurodivergent-led, neuro-affirming support for autistic and/or ADHD children & young people and their families through one-to-one support and parent/carer support groups in the local community.

We also deliver neurodiversity training in schools and workplaces.

Email: hello@neurostars.co.uk

Website: www.neurostars.co.uk

Refresh Carers

Refresh carers:

- Empower parent carers for positive change.
- Run courses and workshops - topics include wellbeing, confidence building, carers rights, creativity and awareness of the skills gained in your parent carer role.
- Set individual goals with each parent carer.
- Run group work and one to one support.
- Signpost and support with SEND issues.

Phone: 07719116103

Email: refreshcarers@gmail.com

Website: www.refreshcarers.com

SENSE children and young people's service

We offer free support for MSI/disabled children and young people up to the age of 25 at home, in school or college.

We have lots of free opportunities for MSI/disabled children to try new things, learn skills and make friends.

We run specialised activities, holidays and play sessions and provide expert advice to support your disabled child every step of the way.

Website: www.sense.org.uk/our-services/support-for-children/



Sensory World

We are a sensory centre. Running clubs and groups for all ages.

Phone: 07801065589

Website: www.sensoryworldplaycentre.co.uk

ZigZag Leeds Autism Support

ZigZag Leeds Autism Support is a charity that supports families and children with a diagnosis of Autism or on the pathway to diagnosis. We have a Facebook parent/carer support group, weekly trampoline sessions and monthly soft play, as well as monthly Parent/carer support groups.

Email: zigzagautismservices@gmail.com

Website: www.zigzagautismservices.com

Little Hiccups

Little Hiccups is an award-winning, Leeds-based, parent-led support charity dedicated to helping families with children who have disabilities or additional needs. Founded by parents who understand the unique challenges of raising a child with complex needs, we provide a safe, inclusive, and welcoming community where families can connect, share experiences, and access vital support.

Email: info@littlehiccups.co.uk

Phone: 07831 230741

Website: www.littlehiccups.co.uk

Scope - support group for parents of children with cerebral palsy

We are Scope, we support disabled people. We are experts in helping people with cerebral palsy and their families.

We host online sessions each term for parents of children with cerebral palsy. Parents choose the topics they need help with. Past sessions included chats, and tips on Educational Healthcare Plans (EHCP). Join us to build a supportive community.

Email: lucy.hindmarch@scope.org.uk

Website: www.scope.org.uk



Sunshine & Smiles - Leeds Down Syndrome Network

Sunshine & Smiles is a registered charity that provides a support network in Leeds for children and young people who have Down syndrome and their families.

We set up in 2011 as a small group offering support in the city and became an official charity in 2013. We are the only specific support network in Leeds and fulfil a vital role in the community.

The Leeds Down Syndrome Support Network is parent led and overseen by a team of three trustees.

We aim to improve the lives and opportunities for children and young people with Down syndrome.

We offer speech and language therapy, regular groups and activities, individual support and advocacy for families, as well as raising awareness and challenging preconceptions in the wider community. We also run two cafes where we employ team members who have Down syndrome.

We work in partnership and establish links with hospitals, health and education professionals and connect with other related charities.

Email: hello@sunshineandsmiles.org.uk

Phone: 07442332678

Website: www.sunshineandsmiles.org.uk

Through the Maze

Through the Maze is an information service for adults with learning disabilities, their families, carers, support staff and other professionals.

We can help you find out about events, activities and groups being run for people with learning disabilities.

We can also signpost you to information and services which are for people with learning disabilities.

Email: ttm@citn.org.uk

Phone: 0113 2703233

Website: www.through-the-maze.org.uk



Carers Leeds

Carers Leeds are the home of support for all unpaid carers in Leeds.

Are you helping a friend or family member due to their illness, disability, mental health issue or a substance misuse problem?

Yes? – Then you are one of 74,000 unpaid carers in Leeds and we are here to support you.

Email: advice@carersleeds.org.uk

Phone: 0113 380 4300

Website: www.carersleeds.org.uk

Leeds Parent Carer Forum

The Leeds Parent Carer Forum is a voluntary organisation led by passionate parents and carers, who are working in partnership with the Local Authority, Education, Health and Social Care services to improve the quality of life for children and young people with additional needs, and their families, across Leeds.

Email: info@leedsparentcarerforum.co.uk

Phone: 07423 436813

Website: www.leedsparentcarerforum.co.uk

Leeds Local Offer

The Leeds Local Offer provides information for children and young people with special educational needs and disabilities (SEND) and their families in a single place.

It shows families what they can expect from a range of local agencies including education, health and social care.

Email: LLO@leeds.gov.uk

Website: www.leedslocaloffer.org.uk

Leeds Sensory Services BID

We provide a comprehensive range of specialist support services for Leeds residents aged 16 and over, who are D/deaf, hard of hearing, sight impaired, severely sight impaired or deafblind.

We deliver services from our city centre office, in the community, at your home and through drop in sessions and activities across the city.

Email: leedsinfo@bid.org.uk

Website: <https://www.bid.org.uk/services/leeds-sensory-services/>



Welfare Rights

Welfare Rights can offer help, advice and information to Leeds residents about any questions you may have related to income or welfare benefits.

Welfare Rights can help:

- complete your benefit forms
- if you are having problems with a benefit office
- with challenging or appealing a benefit
- carry out a benefit check to see what you are entitled to
- answer your questions

The Welfare Rights service is free, and all advice given is impartial and confidential – this means we will not share or pass anything on to anyone else without your consent.

Email: welfare.rights@leeds.gov.uk

Phone: 0113 3760452

Website: www.leeds.gov.uk/benefits/welfare-rights

SENDIASS

Leeds SENDIASS supports children and young people with special educational needs and disabilities (SEND) and their parents/carers.

We do this by providing a free, impartial and confidential service and can advise about things such as:

- SEND support in mainstream schools.
- Preparing for SEND meetings.
- Education, Health and Care (EHC) needs assessments and plans.
- Mediation and SEND tribunal appeals.
- Specialist schools, settings and provisions.
- Preparing for adulthood.
- Preparing for educational transitions.

Email: Leedssendiass@leeds.gov.uk

Phone: 0113 3785020

Website: <https://sendiass.leeds.gov.uk/>



Transport

Independent Travel Training

We help children and young people and children with special educational needs and disabilities (SEND) to travel independently to school or college.

Email: ITTLeeds@leeds.gov.uk

Website: www.leeds.gov.uk/schools-and-education/school-transport/independent-travel-training

West Yorkshire Combined Authority - Inclusive Travel Team (disabled person's travel passes)

The Inclusive Travel Team deal with applications for disabled person's travel passes in West Yorkshire. We can also provide information on the Orange Wallet scheme and Travel Assistance Cards.

Email: inclusivetravel@westyorks-ca.gov.uk

Website: www.wymetro.com



Social Care services

Child Health and Disability Team

CHAD is made up of a number of teams working with children and young people aged 0-18 with complex health needs and disabilities, where their disability has an impact on their ability to be safe, develop skills for life and be part of their local communities growing up.

CHAD is comprised of 3 locality social work teams, the Regional Specialist Team and the Occupational Therapy Team.

Phone:

- CHAD WNW Social Work: 0113 378 4068
- CHAD South Social Work: 0113 378 4915
- CHAD ENE and OT: 0113 378 5140
- Regional Specialist Team: 0113 535 1504 or 0113 535 1499

Website: www.leeds.gov.uk/one-minute-guides/child-health-and-disability

Transitions Team, Leeds City Council

The Transitions Team at Leeds City Council are a dedicated team of social workers who support young people transition from Children's Services into Adult Services. To receive support, a young person must have a diagnosis of a learning disability, autism, severe sensory impairment or complex health needs. They must also already be receiving a funded service before their 18th birthday and be open to a Children's Social Worker or on an Early Help Plan.

Young people who meet the criteria and have a children's social worker are usually allocated a Transitions Worker at around 16½, for young people on an Early Help Plan this is around 17½. The Transitions worker will then work as a secondary worker until the young person is 18. During this period, a Care Act assessment is completed to explore future support needs and plans for adulthood.

When the young person turns 18, the Transitions worker becomes their primary worker. They remain involved until adult support is set up, working effectively, and has been reviewed. At that stage the young person will transfer to the appropriate Adult Social Care team.

The Transitions Team work together to develop the right level of social care support, built around the young person's needs. They work with the young person, their family and professionals to increase independence in preparation for adulthood. They also use a strengths-based approach and work to build on and promote existing support within the family and wider community.

Phone: 0113 378 5940

Website: <https://leedslocaloffer.org.uk/preparing-adulthood/transitions-support>



Early Help and Family Hubs

Family hubs are designed to support families by bringing together a range of services into one easy-to-access space. Whether you need parenting advice, health support, education guidance, or help navigating local services, our family hubs are here to help.

Family hubs act as a vital link between families and community support, offering a holistic approach to meet individual family needs. They are also a space where families can connect with others in their community.

Every Family Hub has a dedicated SEND Coordinator to support children and young people with special educational needs and disabilities (SEND).

Our SEND Coordinators have lots of experience in education, training, and working with families. They're here to help families create a support plan that meets the needs of children and young people. They also offer support and guidance to Early Help partners to connect you with specialist services when needed.

Families can get in touch with their local Family Hub directly or be referred by a professional they're already working with. SEND Coordinators can work directly with families through Early Help, or support professionals to find the right services.

They also work closely with other SEND services across Leeds to make sure support is joined up and consistent. The coordinators also help Early Help partners to identify SEND needs early and put the right support in place.

Email: family.hubs@leeds.gov.uk

Phone: 0113 535 0185

Website: www.leeds.gov.uk/children-and-families/services-for-families/family-hubs

Preparing for Adulthood

Employment and Skills Leeds

Employment and Skills Leeds is part of Leeds City Council.

We connect people and opportunities, promoting access to jobs, training and careers guidance.

Come and chat to our friendly advisors about your post-16 pathways.

Email: esemployers@leeds.gov.uk

Website: www.inclusivegrowthleeds.com/employment-and-skills



Lighthouse Futures Trust (Supported Internships)

Lighthouse Futures Trust is an SPI (Specialist Post 16 Institution) based in Headingley, Leeds. They support young adults with autism and/or learning disabilities to develop the social and employability skills they need to find and keep paid employment.

Pre-Internships with Lighthouse Futures Trust

Their 10-month pre- Internship programme starts in September each year and continues until mid-July. Young people who join this programme are interested in moving into paid employment but are not yet ready for a supported internship. They spend 1-2 years at the College base in Headingley and are offered a rich and varied curriculum with a focus on: employability; skills development; self-confidence; and resilience and wellbeing. They also study for Maths and English if they have not already gained a qualification.

Working in groups of 8-10 people the pre-interns experience different ways of learning – 1-1 coaching, group work, seminars, external visits and much more. In the summer term the aim is for them to benefit from work experience with a range of local companies in Headingley. When they are ready, they then usually transition into the supported internship programme, or they can remain on the pre-internship programme.

Internships with Lighthouse Futures Trust

The 10-month supported internship starts in September each year and continues until mid-July. Interns spend 3 to 4 days a week working with an employer, undertaking a real role working alongside other employees. LFT usually have between 3 and 8 interns working at each employer site and they are supported by one or two job coaches, who are also based on site. Interns then spend 1-2 days in college, studying for qualifications in Maths or English (if not already obtained) and developing other employment-related skills by setting up and running an enterprise project. Towards the end of the internship, job coaches work with interns to help them find paid employment, often with the employer where they have been based or, if not, with another locally-based employer.

Contact Details:

- Tel: 0113 340 0006
- Email adele@lighthousefuturestrust.org.uk



Leeds City College (Supported Internships)

Leeds City College is one of the largest further education institutions in the country with more than 20,000 students. The college provides a vibrant and diverse learning environment, delivering excellent and innovative education which is supportive, inspiring and life changing to ensure every student can take steps towards success.

Leeds City College Supported Internships are personalised and structured work-focused study programmes that help students gain the skills and experience they need to secure a job, through learning in the workplace.

Designed for students with learning difficulties and disabilities, or who need support with managing emotions and behaviour, Supported Internships combine classroom learning with work experience. Students will spend one day a week at Leeds City College with a focus on Maths and English and two days in a work placement, learning real skills and building a portfolio of your work achievements. Our goal is to support students achieve paid employment through the internship placement or within a very similar role.

Students will:

- Receive personalised support based on their needs.
- Get help from our expert job coaches.
- Develop transferable skills for their future career.
- Improve students' confidence and become more independent.

Our Supported Internship programme is extremely personalised and is designed to support progression. To apply for a Supported Internship, you must be a current Leeds City College student, independent traveller and have a minimum of 6 months' work experience in the same field.

Contact details:

- Email: supportedinternships@leedscitycollege.ac.uk



Health

Neurodiversity Information Hub (CYPMHS NHS)

The Neurodiversity Information Hub is a one-stop digital resource to support all neurodivergent children, young people and their families across Leeds.

Website: www.mindmate.org.uk/neurodiversity-information-hub/

Children's Speech and Language Therapy

We help children and young people who have trouble with talking, understanding, or with eating and drinking. These difficulties can make daily life harder, and we're here to support them.

Speech and language therapy can help people with everyday activities like:

- Communicating needs and feelings, so they can ask for help, say what they want, and share how they feel.
- Understanding instructions, for things like getting dressed, following routines, or joining in at school.
- Social interaction, talking with family, making friends, and playing with others.
- Learning and schoolwork, understanding lessons, asking questions, and taking part in class.
- Building independence, using language to make choices and solve problems in daily life.
- Mealtimes, eating and drinking safely without choking or discomfort.

Email: lcht.cslt@nhs.net

Phone: 0113 843 3650

Website: <https://leedscommunityhealthcare.nhs.uk/our-services-a-z/child-speech-and-language-therapy/>

Paediatric Audiologist

We are a Paediatric Audiology Service within the Community.

Providing hearing tests, diagnosis and advice for children age 0-18 years old.



ICAN

We are here to help children and young people with disabilities to achieve their goals by:

- Supporting the participation and inclusion of children, young people with disabilities and their families in everyday activities.
- Empowering children, young people and their families to self-manage conditions and feel in control of their care.
- Identifying and managing underlying impairments such as disabilities and illnesses to prevent or reduce secondary conditions.
- Promoting child wellbeing through safeguarding and healthy lifestyle support.

Email: ican.referrals@nhs.net

Phone: 0113 843 3620

Website: <https://leedscommunityhealthcare.nhs.uk/our-services-a-z/integrated-childrens-additional-needs-service-ican/>

Chatterbug

Chatterbug is a local, award-winning Speech and Language Therapy service based in Leeds. We support children and young people with speech, language and communication needs, offering timely private assessments and personalised therapy plans.

We understand how worrying it can feel when you're waiting for support or unsure what the next step should be. Our experienced therapists take time to listen, explain clearly, and work with you to build a plan that feels right for your child.

Phone: 0113 240 8510

Email: office@chatter-bug.com

Website: www.chatter-bug.com

Health Facilitation Team

The Health Facilitation Team are a strategic team promoting multi agency working by providing free, quality, accessible information that can be used by anyone, but more importantly supports the inclusion of a person with a learning disability.

We support teams understanding about the annual health check.

Phone: 0113 8555 049

Website: www.learningdisabilityservice-leeds.nhs.uk/get-checked-out/



Short Breaks and Fun Activities

Short Breaks and Fun Activities, Leeds City Council

Leeds City Council is committed to delivering a range of Short Breaks for children and young people with Special Educational Needs and Disability (SEND), their parents/carers and families. Short Breaks are activities for children and young people with SEND that enable them to have fun, spend time with friends and build their confidence and skills in a safe environment.

Email: Short.Breaks.Coordinator@Leeds.gov.uk

Website: www.leedslocaloffer.org.uk/health-and-social-care/health-and-social-care/short-breaks-and-fun-activities

Aireborough Supported Activities Scheme (ASAS)

We provide a playscheme for children aged 5-18 with moderate to severe Learning Difficulties and / or physical disabilities who live within the Aireborough area.

We also provide targeted short breaks for children aged 8-18 in the Leeds area at outdoor activity venues such as Lineham Farm

Website: www.Aireborough-scheme.co.uk

Leeds Weekend Care Association

Weekenders Club/Teen Scene:

For children and young people aged between 5 and 18 with moderate to severe disabilities in the Leeds area. We welcome children and young people who would struggle to take up a similar universal activity. Attendance is for 3hrs on a Saturday once every 4 weeks. We are open 47 weeks a year. Once allocated a group, attendance is in the same group each visit.

Out & About Project:

We organise around four events per month for the teens that attend Out and About Project. This is anything from bowling, cinema, eating out, snooker, trampolining, LaserZone, theatre, circus trips, theme park visits (in the school holidays) and local attractions such as Yorkshire Wildlife Park and Stockeld Park... basically anything teens would like to do!

We have trained and experienced staff who already work for us at the Weekenders Club and we staff each trip according to the level of support required. Please note we do not offer one-to-one supervision for this service.

Email: liz.sunderland@lwca.co.uk

Phone: 07506 722 495

Website: www.lwca.co.uk



Northern Ballet

Northern Ballet is the UK's foremost narrative ballet company. We tell unexpected stories that move our audiences.

We believe that everyone can enjoy dance. Whether you're watching or joining in, experienced or brand new to ballet - all our work is designed to be fun, creative and inclusive.

We deliver activities specifically for disabled people including Ability, a course for adults with additional support needs and In Motion, a course for wheelchair users. We also host Expressions, our celebration of inclusive dance every year.

Email: learning@northernballet.com

Phone: 0113 220 8000

Website: www.northernballet.com

MathsCity

MathsCity aims to excite and engage everyone with the fascination and power of mathematics. It is a hands-on space filled with puzzles and interactive activities that invite visitors to explore the wonderful world of maths.

Email: mathscity@mathsworlduk.com

Phone: 07469 195730

Website: www.mathscity.co.uk

People Matters

People Matters work with people with learning differences, run Social Groups, a Micro Social enterprise called Nourishing People, run day time wellbeing groups and also do 1-1 support.

Email: info@peoplesmattersleeds.co.uk



Education

RISE Learning Hub Yorkshire

Resilient Individuals through Support & Education. Alternative learning provision, with a yoga and mindfulness programme, for children aged 4-12years with SEND and /or social, emotional or mental health needs.

RISE supports children and young people who may:

- Have diagnosed or undiagnosed SEND (including autism, ADHD, PDA, sensory processing differences, anxiety, trauma-based needs).
- Be struggling with school attendance or experiencing school-based distress.
- Have been excluded, are at risk of exclusion, or are awaiting provision.
- Find mainstream education overwhelming or unsafe.

Email: riselearninghubyorkshire@gmail.com

Website: www.wellnestkirkstall.co.uk/riselearninghub

Instagram / facebook: @riselearninghubyorkshire

Calibre Audio

Calibre Audio is a national charity who provide audiobooks to people who have a print disability - this is any health condition, disability or learning difference which impacts on the ability to read or enjoy reading print.

Our memberships are completely free of charge for individual children and young adults under 25 years with SEND; schools, nurseries and colleges can also set up free accounts for children to access audiobooks in their education setting.

Come and talk to us about the joy and health/wellbeing benefits of reading through listening!

Email: helen.mee@calibre.org.uk

Website: www.calibreaudio.org.uk

Pivot Academy

Pivot Academies - Leeds and Kirklees - offer a series of EBSA, nurturing, trauma informed therapeutic provisions across our sites.

Leeds has an age range of Year 7 to Year 11. Kirklees has an age range of Year 3 to Year 12.

Both provisions create opportunities to build identity and confidence, develop personal skills and interests, positively re-engage with academic and vocational education in order to establish routines for progression and future success. Staff focus on relevant CPD to support neurodiverse learners and their families.

Email: admissions@pivot-group.co.uk

Phone: 07949 590999

Website: <https://pivot-group.uk>



Learning Inclusion

Sharing our Inclusive Mainstream Practice (IMP) Guidance with parents and carers. IMP Guidance outlines provision and support that mainstream settings should be able to provide for all learners (including those with SEND) in Leeds.

Leeds City College

Leeds City College is one of the largest further education institutions in the country, with more than 20,000 students, and is one of the biggest providers of apprenticeships regionally. Our selection of courses covers almost all subject areas, including academic and vocational qualifications at multiple levels. From apprenticeships, to T Levels and vocational courses, Leeds City College's qualifications ensure every student can take steps towards success.

Email: contact@leedscitycollege.ac.uk

Phone: 0113 386 1997

Website: www.leedscitycollege.ac.uk

Leeds Libraries

Here at Leeds Libraries, you can access a world of reading through thousands of books, audiobooks, online magazines, and comics.

Relax in welcoming spaces, enjoy fun activities and workshops, borrow and reserve books... all for free.

Drop by our stall to find out how to get the best from your Library service and make the most of what we have on offer.

Email: libraryenquiries@leeds.gov.uk

Phone: 0113 378 5005

Website: <https://libraries.leeds.gov.uk/>

Purple Patch Arts

At Purple Patch Arts, we use our unique Purple Patch Approach to support learning-disabled people to thrive and to be heard. Our approach uses creative activities, inclusive learning methods, and creates safe, social environments where everyone is empowered to express themselves, and to engage with, and understand, themselves, other people and the world around them.

Email: info@purplepatcharts.org

Phone: 075103 30105

Website: www.purplepatcharts.org





LIGHTHOUSE
FUTURES TRUST

SUPPORTED INTERNSHIPS

The Supported Internship programme is a one year programme that offers real-life work placements with a range of employers offering a variety of roles including retail, hospitality, healthcare and more!



Aged 18 - 24?
Have an EHCP?
A supported internship
could be for you!

Join us in the Woodhall Room for workshops running throughout the day

- ✓ Immersive work placements with well known national and global employers.
- ✓ Build key employability skills
- ✓ Develop a clear career pathway
- ✓ Helps develop social and communication skills

Tel: 0113 340 0006

Web: www.lighthousefuturestrust.org.uk

Email: info@lighthousefuturestrust.org.uk



**SCAN
FOR
MORE
INFO**



SEND PARENT CARER INFORMATION DROP IN

Speak to services and receive information and advice:

- Leeds Local Offer
- SENDIASS
- Carers Leeds
- Little Hiccups
- Child Health and Disability Team (CHAD)
- Leeds Parent Carer Forum
- Speech and Language Therapy Service
- SEND Coordinators, Family Hubs

Date	Time	Venue
Wed 1 April	10.30 till 12.30	Carr Manor Community Hub, Carr Manor Community School, Stainbeck Lane, LS7 2PS
Wed 13 May	10.30 till 12.30	The Old Fire Station, Gipton Approach, LS9 6NL
Wed 10 June	10.30 till 12.30	Horsforth Library Building, Town Street, Horsforth, LS18 5BL
Wed 8 July	10.30 till 12.30	The Welcome Centre, Belle Isle Rd, Belle Isle, Leeds, LS10 3DN
Wed 9 Sept	10.30 till 12.30	Wetherby Sports Association, The Club House, Lodge Lane, Wetherby, LS22 5FN

Follow Leeds Local Offer on facebook for more info



Follow the Leeds Local Offer

Facebook



WhatsApp



Information and contact details for all the service's at today's event can be found on the Leeds Local Offer (SEND) website at www.leedslocaloffer.org.uk

