

---

# Leeds Local Offer Live Visitor Guide

Wednesday 26th March 2025  
10am till 3pm  
at Pudsey Civic Hall



Website: [www.leedslocaloffer.org.uk](http://www.leedslocaloffer.org.uk)

Facebook: @Leeds Local Offer

Email: [LLO@leeds.gov.uk](mailto:LLO@leeds.gov.uk)



# Welcome to Leeds Local Offer Live 2025!

The Leeds Local Offer provides information for children and young people with special educational needs and disabilities (SEND) and their families in a single place.

It shows families what they can expect from a range of local agencies including education, health and social care.

Today's event is an opportunity for you to speak to a range of services and organisations about their offer and how you and your family can access the service they provide.

**Should you need any help or have any questions, please speak to one of our friendly staff. We are very happy to help you!**



# Event Floorplan: Ballroom

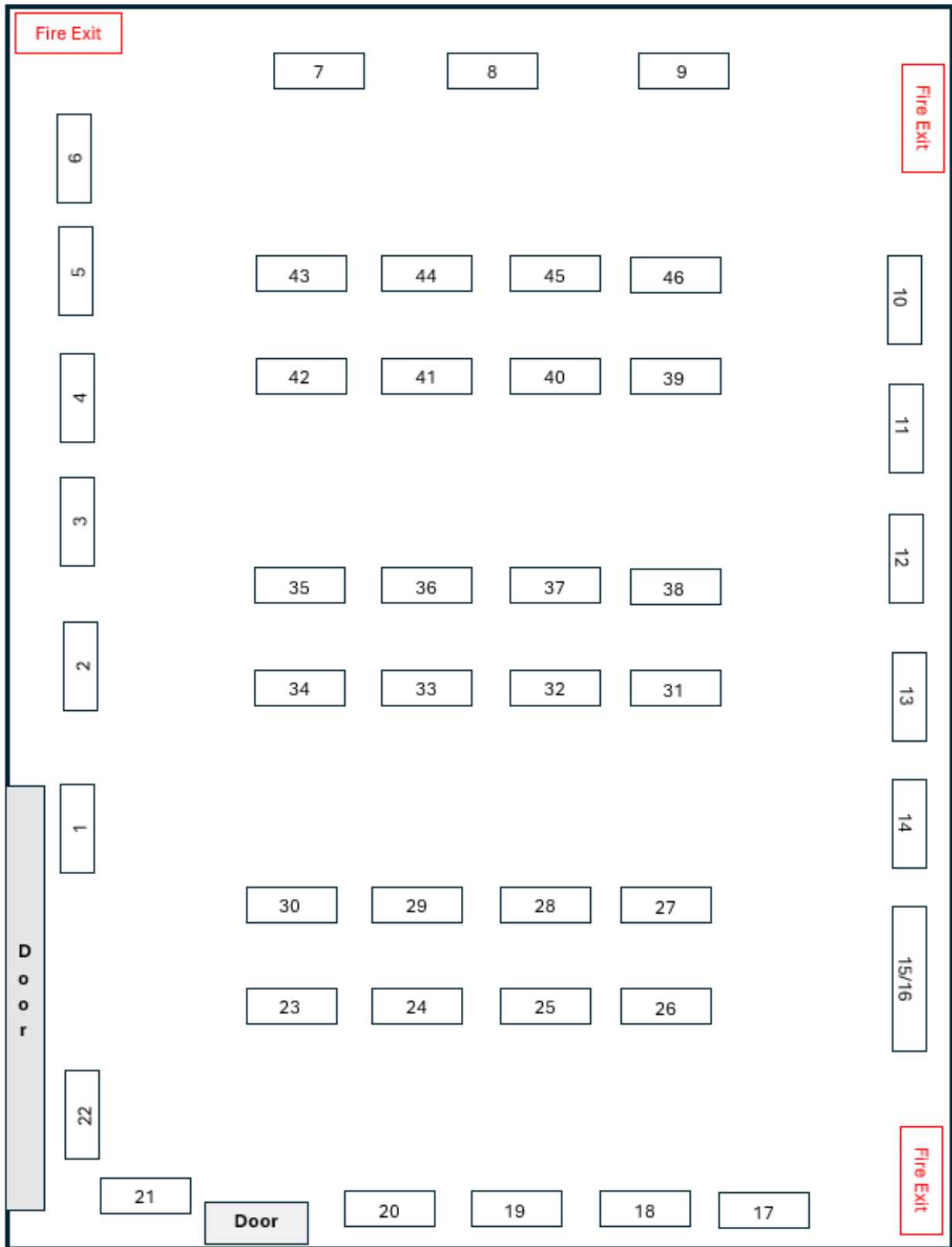

1. Transitions Team, Leeds City Council
2. Child Health and Disability Team
3. Advonet - LEEP1 and Asking You
4. Short Breaks and Fun Activities
5. Energise by Endorphins
6. Accessible Inclusive Music (AIM)
7. Aireborough Supported Activities Scheme
8. Leeds Libraries
9. Yoga with Debs
10. Leeds Mencap
11. Life Without Limits
12. Beamsley Project Charitable Trust
13. Leeds Weekend Care Association
14. Northern Ballet
- 15/16: West Leeds Activity Centre, Herd Farm Activity Centre and South Leeds Youth Hub
17. MindMate Support Team
18. MindMate
19. Neurodiversity (ND) Information Hub, Children and Young People's Mental Health Service (CYPMHS)
20. West Yorkshire Neurodevelopmental Family Navigator Pilot
21. Leeds Parent Carer Forum
22. Leeds Local Offer
23. West Yorkshire ICB
24. Community Audiology
25. Health Facilitation Team, Leeds and York Partnership NHS Foundation Trust
26. Children's Speech and Language Therapy, Leeds Community Healthcare NHS Trust
27. ICAN (Integrated Children with Additional Needs)
28. Leeds Survivor Led Crisis Service
29. Great Minds Together
30. Scope
31. Sensoryworld
32. AFRIKINDNESS
33. Carers Leeds
34. Auditory Verbal UK
35. Lotus Links Peer Support
36. Irwin Mitchell
37. SNAPS (Special Needs and Parent Support)
38. Little Hiccups
39. Zigzag Leeds Autism Support
40. Welfare Rights
41. SENSE MSI Children's Service
42. Kids Yorkshire and Humber
43. Through the Maze
44. Home From Home Care
45. The Spear Programme
46. Employment and Skills, Leeds City Council



# Event Floorplan: Owlcotes Bar

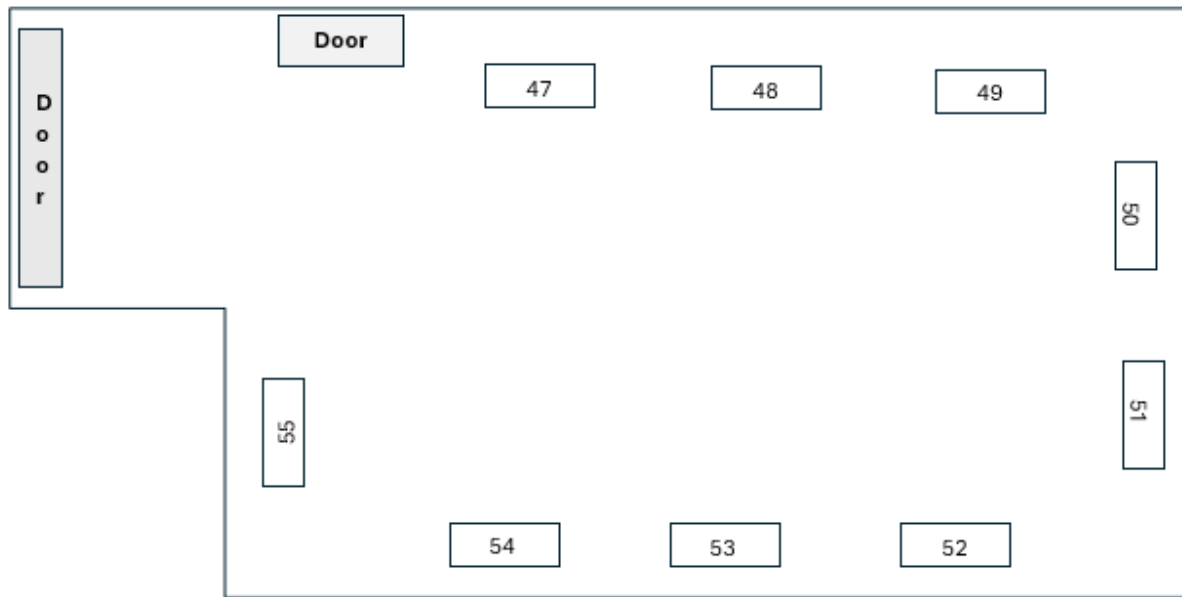

- 47. Purple Patch Arts
- 48. Future Horizons Leeds
- 49. Witherslack Group Specialist Education
- 50. Lifelong Learning Centre, University of Leeds
- 51. Leeds City College
- 52. Henry
- 53/54/55: Leeds SENDIASS



# Education services

## Future Horizons Leeds

Future Horizons Leeds is a specialist post-19 college and social care day provision for adults with complex learning and communication needs.

We prioritise the well-being and personal progress of every young person through organised activities, structured leisure time and physical therapies.

**Email:** [info@futurehorizonsleeds.co.uk](mailto:info@futurehorizonsleeds.co.uk)

**Phone:** 0113 274894

**Website:** [www.futurehorizonsleeds.co.uk](http://www.futurehorizonsleeds.co.uk)

---

## Purple Patch Arts

At Purple Patch Arts we think learning should be fun, creative, joyful and accessible to everyone.

In our Lifelong Learning Programmes across Yorkshire, we use creative methods such as art, drama, music, movement and multi-sensory activity to make learning joyful and accessible for learning-disabled and autistic adults (18+).

**Email:** [info@purplepatcharts.org](mailto:info@purplepatcharts.org)

**Phone:** 07510 330105

**Website:** [www.purplepatcharts.org](http://www.purplepatcharts.org)

---

## Lifelong Learning Centre, University of Leeds

The BA Learning and Teaching with SEND is a part time Undergraduate degree course designed for mature students with caring responsibilities who are supporting SEND in educational settings or the home.

We welcome applicants with life experience of SEND and we provide an alternative entry route for individuals without traditional qualifications.

**Email:** [a.f.collins@leeds.ac.uk](mailto:a.f.collins@leeds.ac.uk)

**Website:** [www.courses.leeds.ac.uk/j553/learning-and-teaching-with-send-ba](http://www.courses.leeds.ac.uk/j553/learning-and-teaching-with-send-ba)



## Leeds City College

At Leeds City College we aim to provide the best possible experience, so that every student is able to develop and progress in their chosen course of study.

Providing diverse and inclusive spaces for you to study in is at the heart of what we do, and with us, you will have world-class facilities to train in. You will also have access to teaching staff who have worked in the industry and who will help you gain insider knowledge as you make decisions about your future.

We're confident that no matter where you are in your educational journey, we can help you reach your full potential.

**Email:** [contact@leedscitycollege.ac.uk](mailto:contact@leedscitycollege.ac.uk)

**Phone:** 0113 3861997 (select option 4)

**Website:** [www.leedscitycollege.ac.uk/](http://www.leedscitycollege.ac.uk/)

---

## Witherslack Group Specialist Education

Witherslack Group are the UK's leading education provider for children and young people with special educational needs as evidenced by sector leading Ofsted judgements and our unmatched placement stability, school attendance and outcomes for young people.

**Phone:** 015395 66725

**Website:** [www.witherslackgroup.co.uk](http://www.witherslackgroup.co.uk)

## Health services

### Children's Speech and Language Therapy, Leeds Community Healthcare NHS Trust

Speech and language therapy helps children and young people improve their talking and communication skills. It involves assessing and providing support for issues with speaking, understanding, and using language. Therapists suggest activities and strategies to support better speech, language, and social interaction.

Your child or young person may have difficulties with swallowing, eating and drinking (dysphagia) and a Speech and Language Therapist can support with this too.

**Email:** [lcht.cslt@nhs.net](mailto:lcht.cslt@nhs.net)

**Phone:** 0113 843 3650

**Website:** [www.leedscommunityhealthcare.nhs.uk/cslt](http://www.leedscommunityhealthcare.nhs.uk/cslt)



## Community Audiology

Leeds Community Audiology is a service provided by Leeds Community Healthcare NHS Trust as part of the children's business unit ICAN services.

We test children's hearing from 0-18 years, we have three dedicated sites across Leeds with sound treated rooms and specialist equipment.

We accept referrals from healthcare and education. We make onward referrals to other services as needed.

---

## Health Facilitation Team, Leeds and York Partnership NHS Foundation Trust

The Health Facilitation Team are part of the Learning Disability Service in Leeds. We work with other healthcare services, for example GP's to help make things better for people with a Learning Disability. We also create easy read accessible information so that people with a Learning Disability are included in their healthcare.

**Email:** [getcheckedout.lypft@nhs.net](mailto:getcheckedout.lypft@nhs.net)

**Phone:** 0113 8555049

**Website:** [www.learningdisabilityservice-leeds.nhs.uk/get-checked-out/](http://www.learningdisabilityservice-leeds.nhs.uk/get-checked-out/)

---

## ICAN (Integrated Children with Additional Needs)

We help children and young people who have additional needs due to developmental delay or disorder by:

- Supporting the participation and inclusion of children, young people with disabilities and their families in everyday activities.
- Empowering children, young people and their families to self-manage conditions and feel in control of their care.
- Identifying and managing underlying impairments such as disabilities and illnesses to prevent or reduce secondary conditions.
- Promoting child wellbeing through safeguarding and healthy lifestyle support.

We do this by working with children and families to find out what goals they most want to achieve. We help to identify any underlying problems and give children and families the information they need to make choices about their care. We work with children, families and other people (such as other health workers, teachers and community workers) to identify the best way for children and young people to achieve their goals. This may involve direct intervention for the child, but may also include support and training for other people or changes to their environment or activities.

**Phone:** 0113 843 3620

**Website:** [www.leedscommunityhealthcare.nhs.uk/our-services-a-z/integrated-childrens-additional-needs-service-ican/](http://www.leedscommunityhealthcare.nhs.uk/our-services-a-z/integrated-childrens-additional-needs-service-ican/)





## MindMate

MindMate Leeds is the name for all the different ways children and young people in the city can get support with their mental health and wellbeing. This website is an information hub about support services, advice and information on common issues, self help guidance, plus young people's stories and experiences.

**Website:** [www.mindmate.org.uk](http://www.mindmate.org.uk)

---

## MindMate Support Team

The MindMate Support Team is an early intervention Mental Health Support Team (MHST). The service is provided by Leeds Community Healthcare Trust and is delivered in partnership with education settings in Leeds. It is part of a national Mental Health Support Team project, commissioned by the government following the 'Transforming children and young people's mental health provision: a green paper'

**Email:** [lcht.mmsupportteam@nhs.net](mailto:lcht.mmsupportteam@nhs.net)

**Website:** [www.mindmate.org.uk/whats-in-leeds-for-me/mmst/](http://www.mindmate.org.uk/whats-in-leeds-for-me/mmst/)

---

## Neurodiversity (ND) Information Hub, Children and Young People's Mental Health Service (CYPMHS)

Neurodiversity (ND) Information Hub is a one-stop digital resource to support all neurodivergent children, young people and their families across Leeds. The resource is created in partnership with Children and Young People's Mental Health Service (CYPMHS) and the West Yorkshire Integrate Care Board (ICB).

**Email:** [lcht.nd.cypmhs@nhs.net](mailto:lcht.nd.cypmhs@nhs.net)

**Phone:** 0113 843 2720

**Website:** [www.mindmate.org.uk/ND](http://www.mindmate.org.uk/ND)

---

## West Yorkshire ICB (Children's DSR/CETR)

We provide oversight of children with a Learning Disability and or Autism who are at risk of hospital admission, placement breakdown or contact with the criminal justice system.

**Website:** [www.england.nhs.uk/long-read/dynamic-support-registers-and-care-education-and-treatment-review-code-of-practice/](http://www.england.nhs.uk/long-read/dynamic-support-registers-and-care-education-and-treatment-review-code-of-practice/)



# Preparing for Adulthood

## Employment and Skills, Leeds City Council

Employment and Skills Leeds is part of Leeds City Council.

We connect people and opportunities, promoting access to jobs, training and careers guidance and supporting employers with their recruitment and skills needs.

We can support you with careers advice and talk you through potential options for the future.

**Email:** [esemployers@leeds.gov.uk](mailto:esemployers@leeds.gov.uk)

**Website:** [www.inclusivegrowthleeds.com/employment-and-skills](http://www.inclusivegrowthleeds.com/employment-and-skills)

---

## Home From Home Care

Our family values make the difference; Home From Home Care provides specialist residential care for adults (18+) with learning disabilities, autism and complex physical health & mental health needs. As an outcomes-focused service, we design bespoke environments, care and support packages around each person to enable them to lead a fulfilled adult life on their own terms. We focus on independence, self-worth and new opportunities as well as build on life skills from education to ensure each individual continues to progress and develop to their fullest potential.

**Phone:** 0800 587 0372

**Email:** [getintouch@homefromhomecare.com](mailto:getintouch@homefromhomecare.com)

**Website:** [www.homefromhomecare.com](http://www.homefromhomecare.com)

---

## The Spear Programme

The Spear Programme helps unemployed young people facing barriers to employment into work or education. We equip them with confidence, motivation and the vital skills they will need.

We believe each young person has huge potential, no matter what barriers to employment they face. On the Spear Programme, we help our trainees realise this potential, by coaching them with the mindset and skills they need to both get into work, education or training and thrive once they're there.

**Website:** [www.resurgo.org.uk/programmes/leeds/](http://www.resurgo.org.uk/programmes/leeds/)



## Through the Maze

Through the Maze is an information service for adults with learning disabilities, their families, carers, support staff and other and professionals.

We can help you find out about events, activities and groups being run for people with learning disabilities.

We can also signpost you to information and services which are for people with learning disabilities.

**Website:** [www.through-the-maze.org.uk](http://www.through-the-maze.org.uk)

# Short Breaks and Fun Activities

## Short Breaks and Fun Activities

Leeds City Council is committed to delivering a range of Short Breaks for children and young people with Special Educational Needs and Disability (SEND), their parents/carers and families. Our aim is to ensure that children and young people with disabilities and their families are supported well and have their needs met.

**Email:** [shortbreaks.coordinator@leeds.gov.uk](mailto:shortbreaks.coordinator@leeds.gov.uk)

**Website:** [www.leeds.gov.uk/schools-and-education/support-for-pupils-with-send/short-breaks-for-disabled-children/short-breaks-service-statement](http://www.leeds.gov.uk/schools-and-education/support-for-pupils-with-send/short-breaks-for-disabled-children/short-breaks-service-statement)

---

## Accessible Inclusive Music (AIM)

Accessible Inclusive Music (AIM) provides musical opportunities for children and young people who are disabled and have additional needs in West Yorkshire and across the UK. Our main offering is our online inclusive choir which is open to all children and young people up to the age of 18 and rehearses every Tuesday at 5pm in term time (free to attend). Participants can join in by singing, signing, moving to the music or using an eye gaze device or switch. Our choir participants have opportunity to choose songs they would like to sing and sign, write their own songs and take musical development exams offered by Trinity College London.

**Email:** [accessible.inclusive.music@gmail.com](mailto:accessible.inclusive.music@gmail.com)

**Website:** [www.accessibleinclusivemusic.org.uk](http://www.accessibleinclusivemusic.org.uk)

---

## Aireborough Supported Activities Scheme

We provide a play scheme for children with additional needs aged 5-18 in the Aireborough area. We also offer activity days and residential for children from ages 8-18 who live in the Leeds area who don't already access overnight respite.

**Phone:** 07764432933 or 07965 245908



## Beamsley Project Charitable Trust

At the Beamsley Project Charitable Trust we are passionate about accessibility and inclusion. We are an independent charity that provides self-catering holiday accommodation which is fully accessible to everyone.

Our specialised facilities are fitted with fixed and mobile hoists, wet rooms, profiling beds, changing tables and much more. We welcome groups and families all year round to the beautiful Yorkshire Dales.

**Phone:** 01756 710 255

**Website:** [www.beamsleyproject.org](http://www.beamsleyproject.org)

---

## Energise by Endorphins

We provide a short break service for children and young people with SEND- Our activities range from arts and crafts, outdoor play, baking and sensory games.

**Email:** [bookings@endorphins.uk](mailto:bookings@endorphins.uk)

**Website:** [www.endorphinsgroup.com](http://www.endorphinsgroup.com)

---

## Life Without Limits

Life Without Limits is a social group for 13-25 year old girls with disabilities and complex needs.

We meet twice a month; Our 'Fun & Activities' session meets at the Vinery Centre where we have workshops including arts, crafts, music, dance and baking. Our 'Out & About' sessions are meet ups in and around Leeds, with activities such as farm visits, bowling, cinema and the theatre.

Places are limited and sessions need to be booked in advance.

**Email:** [info@LifeWithoutLimitsLeeds.org.uk](mailto:info@LifeWithoutLimitsLeeds.org.uk)

**Phone:** 07947 373606

**Website:** [www.lifewithoutlimitsleeds.org.uk](http://www.lifewithoutlimitsleeds.org.uk)

---

## Leeds Libraries

Leeds Libraries is a statutory library service, part of the Communities, Housing and Environment Directorate of Leeds City Council. We have a network of 34 libraries across the city as well as two new Story Buses, which provide a service for children aged under 5 in Leeds.

We have a team of skilled community Librarians who are knowledgeable and passionate about children's literature and information literacy. We understand that reading for pleasure and access to culture is vital for a child's self-development – we are here to share our love of books and reading to support learning and spark the imagination.

**Email:** [leeds.libraries@leeds.gov.uk](mailto:leeds.libraries@leeds.gov.uk)

**Phone:** 0113 3785005

**Website:** [www.libraries.leeds.gov.uk](http://www.libraries.leeds.gov.uk)



## Leeds Mencap

Leeds Mencap is a completely independent charity, started by and for those with learning disabilities. We provide specialist practical, emotional and social support to children and young people with learning disabilities and their families. We offer a Family Support Service, youth clubs and playschemes.

We offer a range of clubs and activities including holiday playschemes, youth clubs, and a social group for adults 18-30. All are fully accessible and available to children and young people with learning disabilities and additional needs. We also run a group for those who have a sibling with additional needs/disabilities.

**Email:** [activities@leedsmencap.org.uk](mailto:activities@leedsmencap.org.uk)

**Phone:** 0113 235133

**Website:** [www.leedsmencap.org.uk/what-we-offer/groups-and-activities/](http://www.leedsmencap.org.uk/what-we-offer/groups-and-activities/)

---

## Leeds Weekend Care Association

We are a local charity that provides weekend and evening social clubs for children and young people with disabilities and additional needs. We have been doing this for over twenty years! All of our projects help young people to have fun, make new friends, try new activities and grow in confidence in a safe, supportive and welcoming space.

Weekenders Club is a play scheme providing a short break for children and young people with additional needs aged 5-18 in the Leeds area.

Weekenders Club is open 47 Saturdays a year. From 1st June 2024 we will operate from The Vinery Centre, 20 Vinery Terrace, East End Park, Leeds, LS9 9LU.

Children and young people who attend Weekenders Club can access the club once every four weeks. Our ½-day sessions are 9.30 a.m. to 12.30 p.m. or 1.30 p.m. to 4.30 pm. When a child is allocated a group, this group stays the same for each visit.

Our staffing level is one staff member/volunteer to one child/young person. All of our staff are experienced and well trained and work alongside dedicated volunteers to enhance the service we provide.

Out & About Project - We organise around three events per month for the teens that attend Out and About Project. This is anything from bowling, cinema, eating out, snooker, trampolining, LaserZone, theatre, circus trips, theme park visits (in the school holidays) and local attractions such as Yorkshire Wildlife Park and Stockeld Park... basically anything teens would like to do!

We have trained and experienced staff who already work for us at the Weekenders Club and we staff each trip according to the level of support required. Please note we do not offer one-to-one supervision for this service.

**Phone:** 07506 722 495 or 07508 240 555

**Website:** [www.lwca.co.uk/](http://www.lwca.co.uk/)



## Northern Ballet

Northern Ballet is the UK's foremost narrative ballet company. We tell unexpected stories that move our audiences.

We believe that everyone can enjoy dance. Whether you're watching or joining in, experienced or brand new to ballet - all our work is designed to be fun, creative and inclusive.

We deliver activities specifically for disabled people including Ability, a course for adults with additional support needs and In Motion, a course for wheelchair users. We also host Expressions, our celebration of inclusive dance every year.

**Email:** [learning@northernballet.com](mailto:learning@northernballet.com)

**Phone:** 0113 220 8000

**Website:** [www.northernballet.com](http://www.northernballet.com)

---

## West Leeds Activity Centre, Herd Farm Activity Centre and South Leeds Youth Hub

West Leeds Activity Centre, Herd Farm Activity Centre and South Leeds Youth Hub deliver fun outdoor activities to children and young people 8 years plus.

Their friendly and welcoming clubs offer children and young people with additional needs the opportunity to have fun, take part in outdoor activities, meet new friends and help them to improve their socialisation and communication skills.

**Email:** [westleedsactivitycentre@leeds.gov.uk](mailto:westleedsactivitycentre@leeds.gov.uk)

---

## Yoga with Debs

Yoga with Debs offers yoga for people with a variety of additional needs and vulnerabilities, including autism, ADHD, Cerebral Palsy, Down's Syndrome, learning disability/ difficulties, PMLD (profound and multiple learning disabilities), sensory difficulties, complex needs, anxiety, OCD and other physical/ mental/behavioural challenges.

Yoga can help young people reach their potential.

**Email:** [debs@yogawithdesb.org.uk](mailto:debs@yogawithdesb.org.uk)

**Phone:** 07857 537905

**Website:** [www.yogawithdebs.org.uk/yoga-for-children-with-additional-needs/](http://www.yogawithdebs.org.uk/yoga-for-children-with-additional-needs/)



# Social Care services

## Advonet - LEEP1 and Asking You

LEEP1: we support people to reach their full potential, and get what they want from the service - we do not set the timetable, you do! Activities all based on what members want and ask for. Giving members the opportunity to do what they want to do - consequently developing skills, building friendships and employment opportunities.

Asking You: We give people with learning disabilities a voice to say what they think about the services they use in Leeds. We want to hear what you think about services you use, and help make sure your voices are heard to make things better.

We offer: planning groups, volunteer-led advocacy for people with learning disabilities, volunteering, consultation and feedback on services, independent service evaluation. We improve services in Leeds by providing user led feedback on those services and learning disability awareness training. We can also support with self-advocacy training and resources. Our Citizen's Advocacy programme matches people with learning disabilities with a volunteer advocate.

### Website:

- [www.leep1.co.uk](http://www.leep1.co.uk)
- [www.askingyou.org.uk](http://www.askingyou.org.uk)

---

## Child Health and Disability Team

The Child Health and Disability Service, often known as CHAD, is made up of a number of teams working with children and young people aged 0-18 with complex health needs and disabilities, where their disability has an impact on their ability to be safe, develop skills for life and be part of their local communities growing up.

The service, which sits with Children and Families Services in the local authority, aims to ensure that every child in Leeds with a complex health need and disability benefits from child-centred, high-quality, flexible and responsive services to help them live a successful and fulfilling life.

Within CHAD there are three locality social work teams, the Regional Specialist Team and the Occupational Therapy Team.

### Phone:

- CHAD WNW Social Work: 0113 378 4068
- CHAD South Social Work: 0113 378 4915
- CHAD ENE and OT: 0113 378 5140
- Regional Specialist Team: 0113 535 1504 or 0113 535 1499

**Website:** [www.leeds.gov.uk/one-minute-guides/child-health-and-disability](http://www.leeds.gov.uk/one-minute-guides/child-health-and-disability)



## Transitions Team, Leeds City Council

The Transitions Team work with young people from 14 to 25 years old who have a diagnosed disability and/or complex health needs.

The Transitions Team are a dedicated group of social workers and health care professionals that work alongside other professionals such as Health and Education.

We work together to develop the right level of social care support, built around the young person's needs. The Transitions Team work with the young person, their family and professionals to increase independence in preparation for adulthood. We also use a strengths-based approach and work to build on and promote existing support within the family and wider community.

**Phone:** 0113 378 5940

**Website:** [www.familyinformation.leeds.gov.uk/send/transitions](http://www.familyinformation.leeds.gov.uk/send/transitions)

# Support for families

## AFRIKINDNESS

Afrikindness Neurodiversity Community Programme

Our Neurodiversity Community Programme is dedicated to supporting neurodiverse individuals, families, and schools. We offer a range of services, including tailored workshops, webinars, and resources that provide parents and caregivers especially from minority ethnic communities with tools to support their neurodiverse children effectively. We also work closely with schools, delivering training sessions and inclusive educational strategies to help educators create supportive learning environments and break barriers with neurodiverse children from African and ethnic minority communities. Our goal is to foster understanding, promote inclusion, and empower both families and schools to embrace and celebrate neurodiversity in their communities.

**Email:** [info@afrikindness.org](mailto:info@afrikindness.org)

**Website:** [www.afrikindness.org](http://www.afrikindness.org)

---

## Irwin Mitchell

Irwin Mitchell is a national law firm with an office in Leeds, providing a range of legal services including services to support your child and family such as public law, court of protection, family, medical negligence and welfare law.

**Email:** [sarah.coles@irwinmitchell.com](mailto:sarah.coles@irwinmitchell.com)

**Phone:** 0113 394 6894

**Website:** [www.irwinmitchell.com](http://www.irwinmitchell.com)





## Auditory Verbal UK

Auditory Verbal UK (AVUK) supports deaf babies and children to learn to listen and speak with Auditory Verbal therapy. Auditory Verbal therapy is a family-centred specialist approach to developing spoken language through listening for deaf children. It supports pre-school deaf children, from birth to five years of age, learn how to make sense of the sound they receive through their hearing technology, like cochlear implants and hearing aids, and develop spoken language so they can learn to talk like their hearing friends.

AVUK's Auditory Verbal therapy family programme includes fortnightly therapy sessions. All therapy sessions are delivered by a highly specialist certified Auditory Verbal Therapist, who is a teacher of the deaf, speech and language therapist or audiologist who has undergone a minimum of three years additional post-graduate internationally accredited training.

As a charity, AVUK is able to offer sessions both in person at its location in north-east Leeds, online or using a hybrid approach of both depending on the needs and preferences of each family. We currently have bursaries for families living in Leeds and beyond to help access our programme.

**Email:** [info@avuk.org](mailto:info@avuk.org)

**Phone:** 01869 325000

**Website:** [www.avuk.org](http://www.avuk.org)

---

## Carers Leeds

Carers Leeds are the home of support for all unpaid carers in Leeds.

Are you helping a friend or family member due to their illness, disability, mental health issue or a substance misuse problem?

Yes? – Then you are one of 74,000 unpaid carers in Leeds and we are here to support you.

**Email:** [advice@carersleeds.org.uk](mailto:advice@carersleeds.org.uk)

**Phone:** 0113 380 4300

**Website:** [www.carersleeds.org.uk](http://www.carersleeds.org.uk)

---

## Great Minds Together

Great Minds Together support children and young people with special educational needs and social, emotional and mental health needs as well as their families and the professional networks around them. The age range of the young people we can support is 0 - 25 years old.

Our organisation exists to prevent one of the three following elements:

- Wrongful hospitalisation.
- Unnecessary Police Intervention.
- Where possible, prevention of children entering the care system by supporting families in an intensive way to ensure positive outcomes.

**Email:** [suzyzito@gmt.team](mailto:suzyzito@gmt.team)

**Website:** [www.greatmindstogether.co.uk/](http://www.greatmindstogether.co.uk/)



## Henry

### 0 to 5 programme

HENRY is a universal offer to all parents and carers who have a child within the family home aged 0-5years. The programme is free 8-week programme and is facilitated by both the 0-19 Public Health Integrated Nursing Service (PHINS) practitioners and Family Help Workers.

Some of the topics discuss are: Managing a child's behaviour, introducing the Eatwell Guide, healthy eating, portion sizes, increasing parental confidence, responding to feelings and behaviours, family rewards systems and dental health

#### **Website:**

<https://www.eventbrite.co.uk/o/leeds-community-healthcare-0-19-phins-73400088013>



### 5 to 12 programme

The HENRY Healthy Families Growing Up Programme is an 8-week course delivered by local HENRY facilitators for parents and carers. HENRY is an inclusive and universal programme for any parent/carer with at least one child aged between 5 and 12 years.

HENRY is ideal for any family who would like to find out how the whole family can become healthier and happier together. Our programmes explore key themes such as; well-being, whole family lifestyle habits, mealtimes, TV, sleep, food, behaviour, setting boundaries, parenting and physical activity. Programmes are delivered across Leeds and online and there is no cost to attend.

**Email:** HENRY5-12@leeds.gov.uk

**Website:** [www.schoolwellbeing.co.uk/pages/henry-5-12-parent-s-page](http://www.schoolwellbeing.co.uk/pages/henry-5-12-parent-s-page)



---

## Kids Yorkshire and Humber

We're here for children and young people with special educational needs and disabilities, young carers and families. We're on a mission to create a world where all kinds of kids have all kinds of opportunities. Childhood should be a joyful time. But some children and young people with special educational needs and disabilities are defined by what they cannot do. That's wrong.

Every child should have an equal opportunity to play, learn, grow and thrive.

**Email:** [angela.knight@kids.org.uk](mailto:angela.knight@kids.org.uk)

**Website:** [www.kids.org.uk](http://www.kids.org.uk)

---

## Leeds Local Offer

The Leeds Local Offer provides information for children and young people with special educational needs and disabilities (SEND) and their families in a single place.

It shows families what they can expect from a range of local agencies including education, health and social care.

**Email:** [LLO@leeds.gov.uk](mailto:LLO@leeds.gov.uk)

**Website:** [www.leedslocaloffer.org.uk](http://www.leedslocaloffer.org.uk)



## Leeds Parent Carer Forum

The Leeds Parent Carer Forum is a voluntary organisation led by passionate parents and carers, who are working in partnership with the Local Authority, Education, Health and Social Care services to improve the quality of life for children and young people with additional needs, and their families, across Leeds.

**Email:** [info@leedsparentcarerforum.co.uk](mailto:info@leedsparentcarerforum.co.uk)

**Phone:** 07423 436813

**Website:** [www.leedsparentcarerforum.co.uk](http://www.leedsparentcarerforum.co.uk)

---

## Leeds SENDIASS

Leeds SENDIASS (Special Educational Needs and Disability Information Advice and Support Service) is a statutory service that provides information, advice and support on matters relating to Special Educational Needs and Disabilities (SEND)

**Email:** [leedssendiass@leeds.gov.uk](mailto:leedssendiass@leeds.gov.uk)

**Phone:** 0113 3785020 (voicemail service)

**Website:** [www.sendiass.leeds.gov.uk](http://www.sendiass.leeds.gov.uk)

---

## Little Hiccups

Little Hiccups is an award winning, Leeds based support group that has been set up by parents who have children with additional needs and disabilities.

Through personal experience we recognise the importance of allowing the parents and families of a child with an additional need or disability the opportunity to meet people in similar situations, to make friends and support each other.

We know that to every family that this is an individual journey but we also recognise the importance of sharing the events of that journey with other people in similar situations. We offer a range of support from our Outreach Programme for those families that are just not quite ready to come to one of our sessions. But for those that are, we offer a variety of support from Stay n Play to monthly Family Fun Days.

**Email:** [info@littlehiccups.co.uk](mailto:info@littlehiccups.co.uk)

**Phone:** 0783 123 0741

**Website:** [www.littlehiccups.co.uk/](http://www.littlehiccups.co.uk/)

---

## Lotus Links Peer Support

We are a voluntary led peer support service for parent/carers of SEND children experiencing distressed behaviours (physical violence etc.) We offer emotional support and a non judgemental space to share experiences, meet others and share strategies/ideas. We also host speaker/training events based on the needs of our members and a monthly drop-in.

**Email:** [lotuslinks\\_ps@outlook.com](mailto:lotuslinks_ps@outlook.com)

**Website:** [www.facebook.com/lotuslinkspeersupportleeds/](http://www.facebook.com/lotuslinkspeersupportleeds/)



## Leeds Survivor Led Crisis Service

Safe Zone is a free, on-the-night face-to-face mental health crisis support service for 11–17 year-olds and their parents/carers living in Leeds, BD4, BD11, WF3 and WF10, who need someone to talk to in a safe and confidential setting.

Safe Zone is staffed by experienced workers from Leeds Survivor Led Crisis Service (LSLCS) who can offer around 45 minutes of emotional and practical support.

Safe Zone provides a hybrid approach, combining face-to-face support and telephone support from 4.00–10.00 pm, two days a week. Face-to-face support takes place at the following different locations:

Wednesday: Northpoint Wellbeing, Small Mill, Chadwick Street, LS10 1LJ

Thursday: Dial House, 12 Chapel Street, LS15 7RW

### Teen Connect

We listen – We care – We won't judge

Open every day of the year: Mon–Fri 3.30pm–2am; Sat–Sun 6pm–2am

What's Teen Connect?

Teen Connect is a helpline for 11–18 year-olds living in the Leeds area. We can offer up to an hour of support either by phone, text or online chat. You can have up to an hour with one of our trained staff each night to talk about what you're going through.

Who will support me?

All our staff have training in counselling skills. We're not a call centre – we are a small, friendly team of people and we all have some experience ourselves of managing our own difficulties.

### Making a referral

SafeZone

To make a referral, please call 0113 819 8189 or 07593 529367 between 16:00-20:30 on the day of support, with the last referral being taken at 20:30. Referrals operate on a first-come, first-served basis.

Teen Connect

You can get support with us in three different ways:

- Call us on 0808 800 1212 – if we can't pick up, leave us a voice message and we'll call you back as soon as we can.
- Text us on 07984436680 and a member of staff will let you know when someone will be available to call or chat online with you.
- Go online by clicking the button at the top of the page or click here. If we can't support you right away, someone will let you know what time we can be available.

### Website:

- [www.lslcs.org.uk/services/connect-helpline/teen-connect/](http://www.lslcs.org.uk/services/connect-helpline/teen-connect/)
- [www.lslcs.org.uk/services/safe-zone/](http://www.lslcs.org.uk/services/safe-zone/)



## Scope

Scope has opened a Community Hub in Leeds. Our aim is to support local disabled people and their families.

There is a cerebral palsy specialist based in the Hub. They offer support to people with cerebral palsy and their families.

We offer community events and workshops for parents and carers of disabled children.

**Email:** [lucy.hindmarch@scope.org.uk](mailto:lucy.hindmarch@scope.org.uk)

**Website:** [www.scope.org.uk/](http://www.scope.org.uk/)

---

## SENSE MSI Children's Service

Sense supports children and young people aged 0-25 years, who are deafblind or multi-sensory impaired (MSI), and their families. We're here to enable everyone to communicate, play and explore the world around them.

**Email:** [info@littlehiccupps.co.uk](mailto:info@littlehiccupps.co.uk)

**Phone:** 0783 123 0741

**Website:** [www.sense.org.uk/msi-support](http://www.sense.org.uk/msi-support)

---

## Sensoryworld

We are a sensory centre providing a safe space for all ages to come relax and play.

**Phone:** 07801 065589

**Website:** [www.sensoryworldplaycentre.co.uk](http://www.sensoryworldplaycentre.co.uk)

---

## SNAPS (Special Needs and Parent Support)

SNAPS (Special Needs and Parent Support) is a Leeds-based registered charity (No. 1171244) dedicated to supporting children with additional needs and their families whether you have a diagnosis or not. SNAPS provides a range of services, including hydrotherapy, rebound therapy, swimming, football, arts and crafts activities, as well as family support and holiday events, aiming to enhance the quality of life for both the children and their whole family. The charity creates a welcoming and inclusive environment where families can connect, share experiences, and access vital resources. SNAPS focuses on empowering families by offering practical assistance, social opportunities, and a strong support network.

**Email:** [info@snapsyorkshire.org](mailto:info@snapsyorkshire.org)

**Website:** [www.snapsyorkshire.org/](http://www.snapsyorkshire.org/)



## Welfare Rights

Leeds City Council's Welfare Rights Unit can:

- give free, confidential, impartial advice and support on a whole range of welfare benefits.
- help to complete claim forms over the phone.
- forms completed are posted to clients to sign, check and forward to the right department.
- offer guidance and support when making appeals.
- check for benefit entitlement and give guidance on using benefit systems.

**Email:** [welfare.rights@leeds.gov.uk](mailto:welfare.rights@leeds.gov.uk)

**Phone:** 0113 376 0452

**Website:** [www.leeds.gov.uk/benefits/welfare-rights](http://www.leeds.gov.uk/benefits/welfare-rights)

---

## West Yorkshire Neurodevelopmental Family Navigator Pilot

The West Yorkshire Neurodevelopmental Family Navigator Pilot improves the support for families who are waiting for neurodevelopmental assessment and increase capacity in the system for parental support.

The Pilot works:

- To provide pre-diagnostic peer support.
- Where possible, introduce experts by experience to help improve service experience.
- To prevent potential crisis and deterioration of wellbeing for the family.
- To involve parents/carers in improving service delivery.
- To have relevant information and signposting to local community support.

**Website:** [www.barnardos.org.uk/get-support/services/west-yorkshire-neurodevelopmental-family-navigator-pilot](http://www.barnardos.org.uk/get-support/services/west-yorkshire-neurodevelopmental-family-navigator-pilot)

---

## ZigZag Leeds Autism Support

ZigZag has been supporting thousands of families with autistic children for over 20 years. We offer a wide range of services designed to meet the needs of the entire family.

Our services include:

- Online advice and peer support through private Facebook groups.
- Parent/Carer meetings.
- Monthly soft play sessions.
- Twice-weekly trampoline sessions.
- Special holiday activity programs.
- Parent/Carer social events.
- Affordable autism awareness training.
- Book lending library.
- Information, advice, and referrals to relevant service providers.

**Website:** [www.zigzagautismservices.co.uk](http://www.zigzagautismservices.co.uk)



# SEND PARENT CARER INFORMATION DROP IN

Speak to services and receive information and advice:

- Leeds Local Offer
- SENDIASS
- Carers Leeds
- Child Health and Disability Team (CHAD)
- Leeds Parent Carer Forum
- Speech and Language Therapy Service

Date	Time	Venue
Wed 2 April	10.30 till 12.30	NSPCC, 5th Floor, St John's Offices, Albion Street, LS2 8LQ
Wed 21 May	10.30 till 12.30	Plus Net, 17 Marlborough Street, Leeds, LS1 4PE
Wed 18 June	10.30 till 12.30	Plus Net, 17 Marlborough Street, Leeds, LS1 4PE
Wed 9 July	10.30 till 12.30	Plus Net, 17 Marlborough Street, Leeds, LS1 4PE
Wed 17 Sept	10.30 till 12.30	Plus Net, 17 Marlborough Street, Leeds, LS1 4PE

**There will be a workshop available at each drop in**

**Follow Leeds Local Offer on facebook for more info**







**LEEDS PCF**  
PARENT CARER FORUM

Leeds Parent Carer Forum (LPCF) is a new organisation led by local parents working to represent the views of parents and carers of children and young people with Special Educational Needs and Disabilities (SEND)

We work in partnership with the Local Authority, Education, Health & Care services to make a positive difference for children and families in Leeds

**Register** with us via our website [www.leedsparentcarerforum.co.uk](http://www.leedsparentcarerforum.co.uk) to keep up to date with the work we are doing.

Scan the QR code to find out more about our events:



**Leeds Parent Carer Forum (Leeds PCF)**

Working to represent the voices of parents and carers of children with SEND in Leeds

[www.leedsparentcarerforum.co.uk](http://www.leedsparentcarerforum.co.uk)  
[facebook.com/leedspcf](https://facebook.com/leedspcf)  
[info@leedsparentcarerforum.co.uk](mailto:info@leedsparentcarerforum.co.uk)

Proudly supported by

**IM, irwinmitchell**



# SEND Next Choices

Getting ready for adult life



## Tuesday 24 June 2025

Leeds first direct arena

Scan the QR code to book your free ticket or visit [bit.ly/send25](https://bit.ly/send25)



This event will bring together a wide range of organisations who can answer your queries about what to do next if you have a special educational need and/or a disability. Find out about jobs, training, apprenticeships, college courses, supported internships, voluntary work, leisure activities, finances, benefits and organisations who can help you.

Young people, parents, carers, teachers and support workers are all welcome!



Information and contact details for all the service's at today's event can be found on the Leeds Local Offer (SEND) website at [www.leedslocaloffer.org.uk](http://www.leedslocaloffer.org.uk)

Website: [www.leedslocaloffer.org.uk](http://www.leedslocaloffer.org.uk)

Facebook: @Leeds Local Offer

Email: [LLO@leeds.gov.uk](mailto:LLO@leeds.gov.uk)

